

GENERAL HINGE INFORMATION

Special Situation Products

- “CE” Concealed electric hinges conduct current regardless of door position to electric locks, exit devices, or hold open devices where tamper-proof hinge is required. Also to transmit signals from code readers on doors to remote computers for access control
- No electrical parts are exposed when hinge is installed
- Permanent fast pin
- Hinges should be installed in the center hinge location
- Not available as swing clear or raised barrel
- Hinges may be equipped with both concealed wires and concealed switches. When both are desired on the same hinge use prefix “CECS”
- Packed one per box with all machine screws and installation instructions
- When ordering specify class number, size, finish and number of wires
Suffix -54 for 4 wires, 56 for 6 wires -66 for 6 wires (2@24AWG, 4@28AWG), 58 for 8 wires or 10 for 10 wires
- Should be used along with a junction box
- Can be furnished with hospital tips

CECB179
CECB168
CECB191
CECB199
5-Knuckle
Concealed
Bearings



CEFBB179
CEFBB168
CEFBB191
CEFBB199
5-Knuckle
Exposed
Bearings



CECB1900R
CECB1901R
CECB1960R
CECB1961R
3-Knuckle
Concealed
Bearings



Not
Handed



Not
Handed



Handed
Specify
RH or LH



Electrical Ratings

Suffix	# Wires	Wire Gage	Volts (AC or DC)	
			6, 12, 24	48
			Current	
-54	4	28AWG	1 amp/wire	5 milli-amp/wire
-56	6	28AWG	.7 amp/wire	5 milli-amp/wire
-58	8	28AWG	.5 amp/wire	5 milli-amp/wire
-10	10	28AWG	.4 amp/wire	5 milli-amp/wire
-66*	6	2@24AWG	2 amp/wire	5 milli-amp/wire
		4@28AWG	1 amp/wire	5 milli-amp/wire

Inrush 15A for .05 second/wire

“CE” hinges are listed by UL at these ratings

* Not available in FBB168 and FBB199

Class Number

Class Number	Sizes Available	
CB179, FBB179, CB1900R	4 1/2" x 4"	(114mm x 102mm)
CB168, FBB168, CB1901R	4 1/2" x 4 1/2"	(114mm x 114mm)
CB191, FBB191, CB1960R	5" x 4"	(127mm x 102mm)
CB199, FBB199, CB1961R	5" x 4 1/2"	(127mm x 114mm)
	5" x 5"	(127mm x 127mm)
	6" x 4 1/2"	(152mm x 114mm)
	6" x 5"*	(152mm x 127mm)
	6" x 6"*	(152mm x 152mm)

* Not available in CB191, FBB191, CB1900R and CB1960R

JB2R – Junction Box

- Note: Install in middle hinge location
- Can be shop welded or field installed — before frames are set
- Fits either 4 1/2" (114mm) or 5" (127mm) size hinges

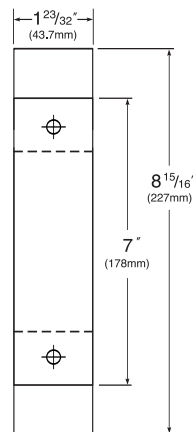
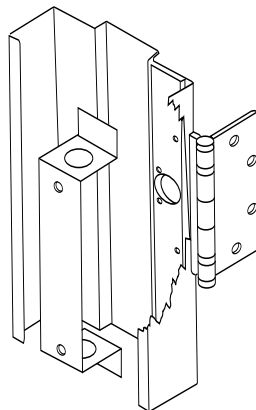

Junction Box
Top View

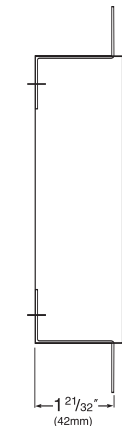

Right Side
View